

KIT DIVISOR HORIZONTAL INSTRUCCIONES DE MONTAJE

HORIZONTAL PARTITION KIT ASSEMBLY INSTRUCTIONS

ELEMENTOS DEL KIT

KIT ELEMENTS

Perfil H horizontal
Horizontal H profile
1,5m

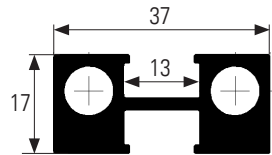

Perfil reductor para vidrio 6mm
6mm transparent gasket
2 x 1,5m



Elementos de unión
Joint elements x4

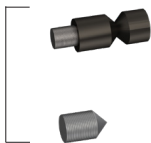

Brocas
Drills



Plantilla
Template



CALCULO DE MEDIDAS PREVIO MEASURES ESTIMATION

CALCULO DE LAS MEDIDAS TOTALES DE LA PUERTA
DOOR TOTAL MEASURES

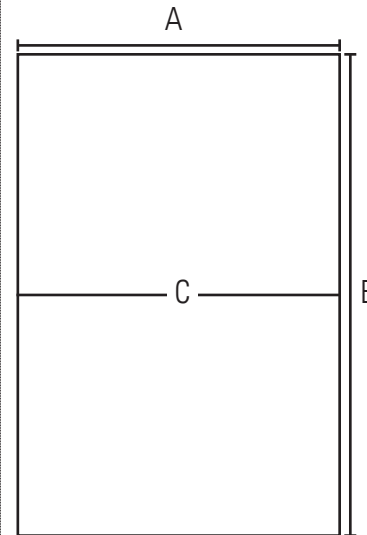

A = Anchura puerta / Door width
B = Altura puerta / Door height
C = Divisor horizontal / Horizontal partition

CALCULAR LAS MEDIDAS DE LOS PERFILES.
PROFILES MEASURES

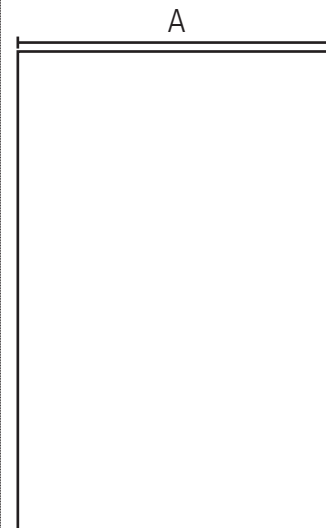

Perfil horizontal superior e inferior= A - 24mm
Horizontal upper and lower profile = A - 24mm

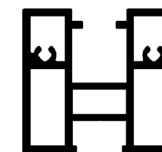

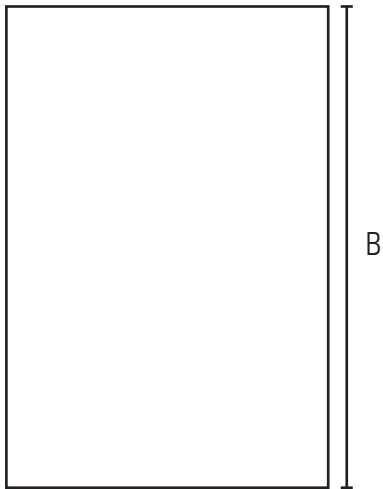

Perfil vertical = B
Vertical profile = B



B

CALCULO PARA PARTIÇÃO HORIZONTAL
 ESTIMATION HORIZONTAL PARTITION

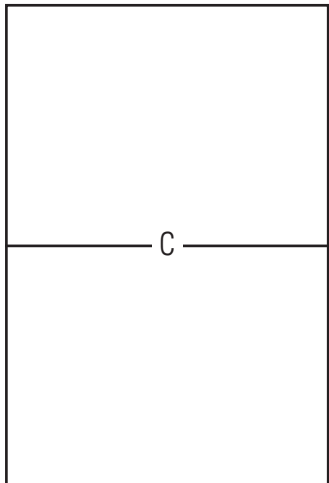

Divisor horizontal (C) = A - 24mm
Horizontal partition (C) = A - 24mm



C

ADINOR



Para calculo de mecanizado de perfiles y dimensiones de vidrios:
For estimation of vertical profiles machining and glass dimensions:

http://www.adinor.info/wp-content/uploads/kit_divisor_horizontal.xlsm

CALCULO PARA PARTIÇÃO MEDIA EN EL PERFIL VERTICAL
 ESTIMATION HORIZONTAL PARTITION

IMPORTANTE
IMPORTANT

El perfil horizontal - partición debe ser taladrado siempre en la siguiente cara:
 Horizontal partition profile must be drilled on the thick surface:

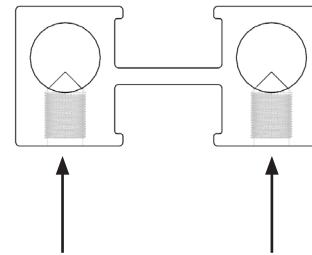

Para una instalación en la que el prisionero quede oculto a la vista puede voltearse el perfil pero debe tenerse en cuenta un desplazamiento de 2,25mm que afectara a la medida del vidrio.

For hiding socket screws, you could rotate the profile but you have to consider the center displacement 2,25mm that will affect the glass measures.

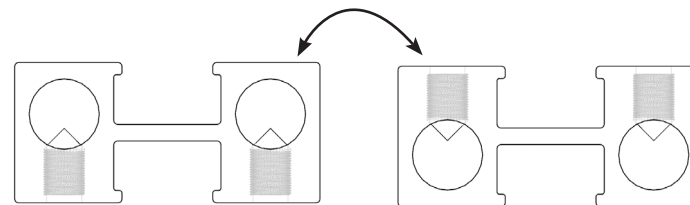
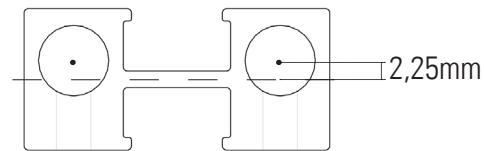

ADINOR

Opción 1: Vista del perfil horizontal divisor prisioneros arriba
Option 1: Horizontal partition profile view with socket screws looking up

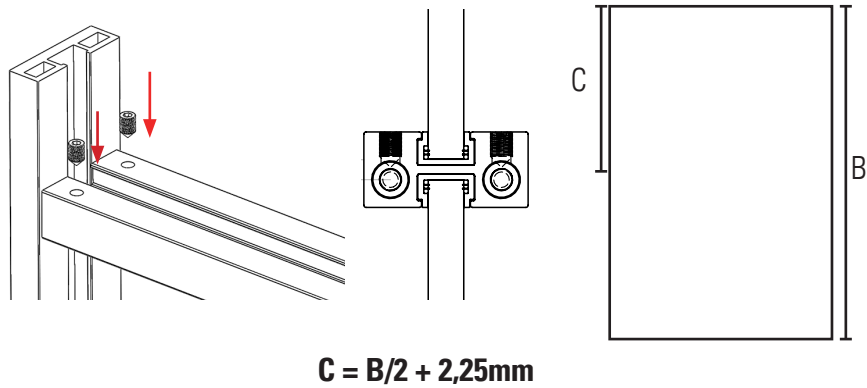

$$C = B/2 + 2,25\text{mm}$$

Opción 2: Vista del perfil horizontal divisor prisioneros abajo
Option 2: Horizontal partition view with socket screws looking down

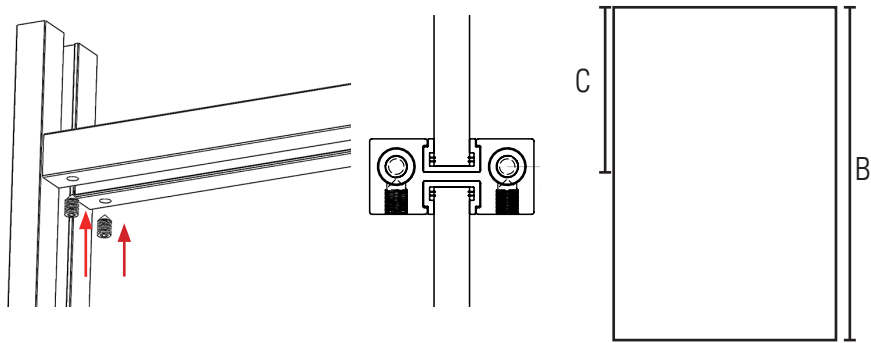

$$C = B/2 - 2,25\text{mm}$$

ADINOR

PASO 1 TALADRAR EL PERFIL VERTICAL

STEP 1 VERTICAL PROFILE DRILL

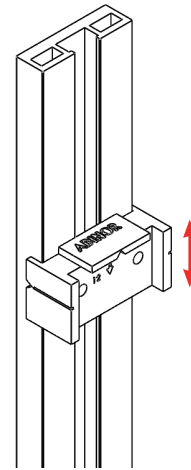

Deslizar y buscar la altura a la que se quiere taladrar.

Slide and look for the desired drilling height

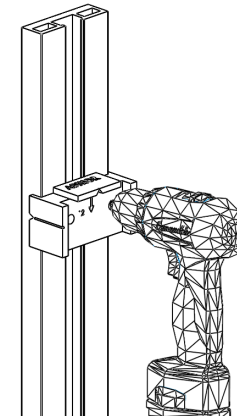

Taladrar con la broca de 4,25mm

Use 4,25mm drill

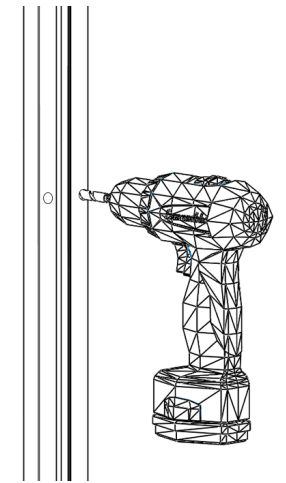

Roscar con el macho M5

Thread with M5 drill

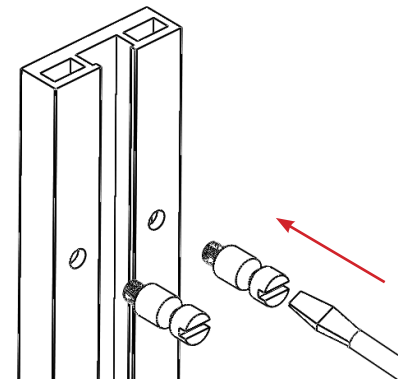

Roscar los pernos de sujeción
Thread the joint elements

ADINOR

PASO 2 TALADRAR EL PERFIL HORIZONTAL

STEP 2 HORIZONTAL PROFILE DRILLING

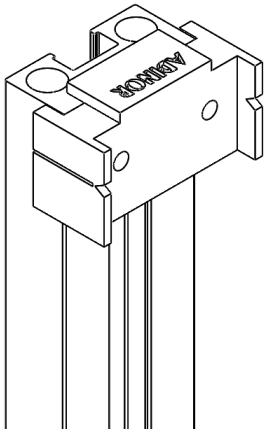

Asegurarse de que la plantilla esta bien situada en el inicio del perfil.

Template must be placed at the head profile.

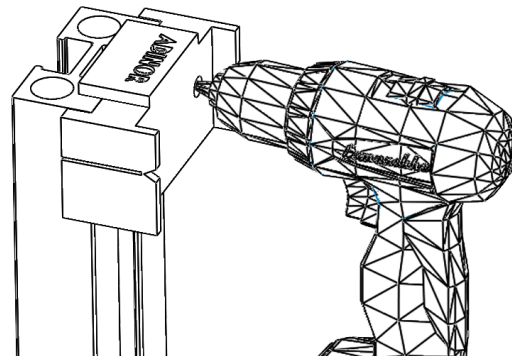

Taladrar con la broca de 4,25mm

Use 4,25mm drill

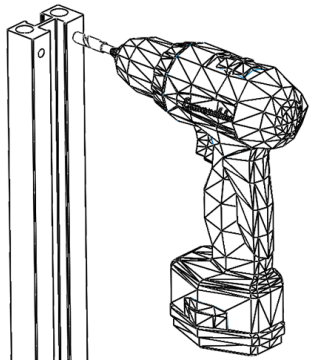

Roscar con el macho M5

Thread with M5 drill



ADINOR

PASO 3 FIJAR EL PERFIL HORIZONTAL AL VERTICAL CON LOS PRISIONEROS

STEP 3 FIX HORIZONTAL AND VERTICAL PROFILE WITH JOINT ELEMENTS

OPCION A: TORNILLOS ABAJO

OPTION A: SCREWS DOWN

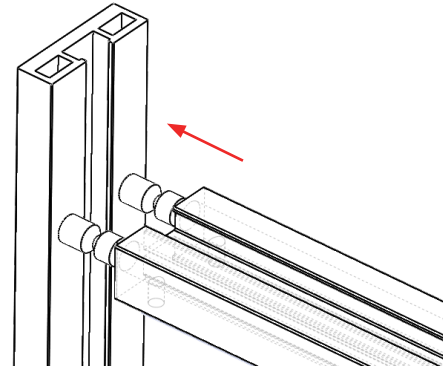

Introducir el perfil horizontal en los pernos de fijación atornillados en el perfil vertical.

Introduce the horizontal profile in the vertical joint elements threaded in the vertical profile in the step 1.

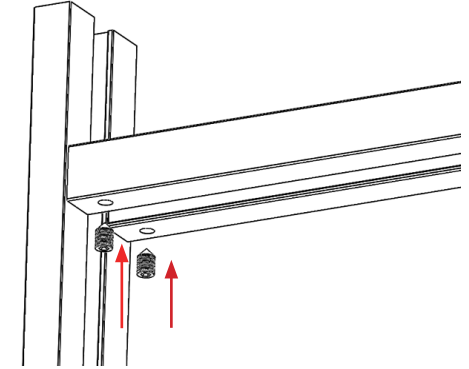

OPCION B: PRISIONEROS ARRIBA

OPTION B: SOCKET SCREWS ABOVE

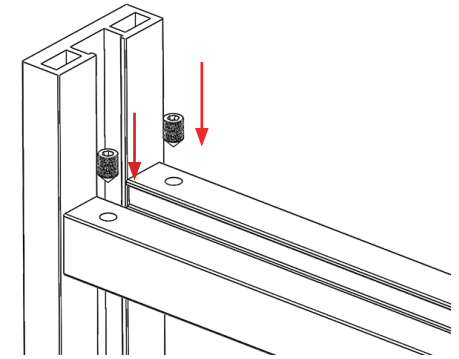

Fijar perfiles horizontal y vertical con los prisioneros
Tener en cuenta posicionamiento de perfil (ver paso 2)

Fix horizontal and vertical profiles with joint elements.
Be aware of the position of the horizontal profile (check step 2.)

ADINOR